

SPECIFICATION SHEET

Azar - Flueless Fire

Index # 89, Rev-1 / 9-March-2010

Page 1 of 2

MATERIAL OPTIONS:

Fire Internal Finish: Satin Black Steel.
Fascia Options: Satin Black Steel or Brushed Stainless Steel.

CE APPROVAL:

Currently CE tested, approved and available for the following countries:

NG - I2H - G20 - 20mBar

UK, EIRE, AUSTRIA, SWITZERLAND, CZECH REPUBLIC, SPAIN, GREECE, FINLAND, ITALY, PORTUGAL & SWEDEN.

NOTE: Natural Gas Only

DIMENSIONS:

Overall dimensions of the Fire & surround: HEIGHT: 800mm x WIDTH: 695mm x DEPTH: 130mm

Fascia Opening Size : HEIGHT: 350mm x WIDTH: 265mm

FIRE POWER RATING:

High and low flame setting (gas only):

Heat input high: NG - 2.35KW

Heat input low: NG - 1.4KW

Approximate running cost per hour on low (subject to your gas supplier tariff): NG 2.6p.

“Minimum” Room Size = 24 m3

Free Air Wall Vent Size = 100 cm2

Running Cost [on High] = Approx 6p/Hour (subject to your gas supplier tariff)

OTHER TECHNICAL INFORMATION:

1. This is an **Open Flamed Flueless Appliance** with Ceramic Matting to give a sparkling Effect when lit.
2. The Matting should not be touched otherwise damage will occur.
3. Safety ODS (Oxygen Depletion System) fitted as standard to monitor oxygen levels in the room.
4. Fire is available for NG only. Supply Pressure: **NG 20mbar**
5. Simple “Hung on the Wall” Design
6. **Ventilation Requirements:**
 - a. The room in which the fire is to be installed will require a wall vent of at least 100cm².
 - b. The room in which the fire is to be fitted must have a window that can be opened if required.
 - c. The vent must be positioned at least 1m away from the appliance.
 - d. The fire must not be fitted in an internal space area of “less” than 24m³ in volume, adjoining spaces not separated by a door may be included.
 - e. Example Room Space Calculation - 2.5m x 3.1m x 3.5m = 27m³.
 - f. To convert to cubic feet (ft³) to cubic metre (m³), divide the room’s volume in cubic feet by 35.3.
7. Manual Control ignition system as Standard.
8. A remote control version is available upon request and requires a 240v 3A supply.

Spirit Fires Limited reserve the right to amend and improve any of the specification sheets without prior notice.

All fires are living flames. Sooting can occur as a natural bi-product of a living flame and cannot be controlled or eliminated. Weathering and sooting of the enclosures is a natural and normal occurrence. This, understandably is more obvious on light coloured materials such as white stone and white powder coated steel.

Cast bronze and cast iron are hand sand cast and polished. Pitting and air holes are normal and a part of the unique quality of such a piece.

NOTE - The low-rate on the burner unit has a running noise level due to the nature of the gas flow rate through the valve. This is normal for the size of this fire.

Spirit Fires Ltd, 4 Beaumont Square Durham Way South Aycliffe Industrial Park
Newton Aycliffe County Durham DL5 6SW
Tel: +44 (0) 1325 327 221 Fax: +(0)1325 327 292
Email info@cvo.co.uk

www.spiritfires.co.uk

Spirit Fires Incorporates the full CVO Fire range of Fires. For more details contact above or visit www.cvo.co.uk

CVO FIRE 

SPIRIT FIRES

SPECIFICATION SHEET

Azar - Flueless Fire

Index # 89, Rev-1 / 9-March-2010

Page 2 of 2

Top View

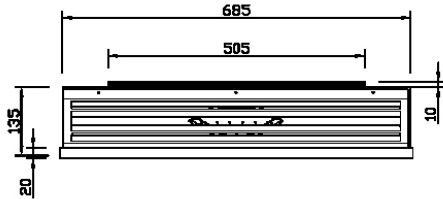

Perspective View

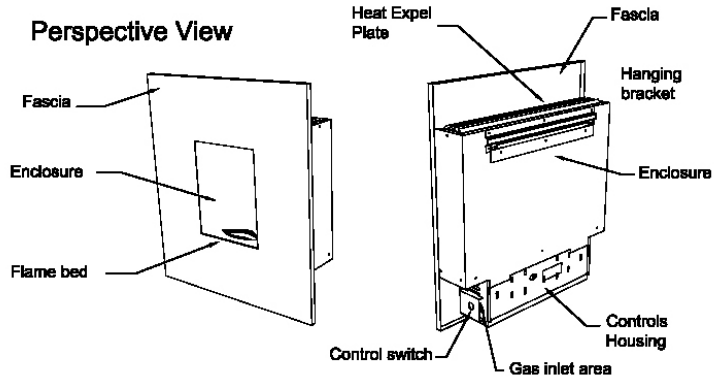

Front View

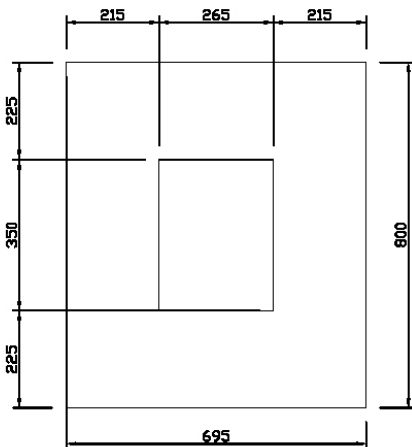

Side View

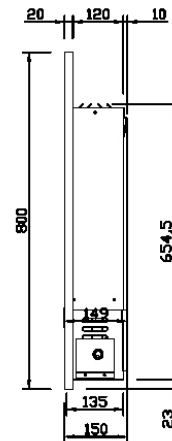

Spirit Fires Limited reserve the right to amend and improve any of the specification sheets without prior notice.
 All fires are living flames. Sooting can occur as a natural bi-product of a living flame and cannot be controlled or eliminated. Weathering and sooting of the enclosures is a natural and normal occurrence. This, understandably is more obvious on light coloured materials such as white stone and white powder coated steel.
 Cast bronze and cast iron are hand sand cast and polished. Pitting and air holes are normal and a part of the unique quality of such a piece.
 NOTE - The low-rate on the burner unit has a running noise level due to the nature of the gas flow rate through the valve. This is normal for the size of this fire.

Spirit Fires Ltd, 4 Beaumont Square Durham Way South Aycliffe Industrial Park
 Newton Aycliffe County Durham DL5 6SW
 Tel: +44 (0) 1325 327 221 Fax: +(0)1325 327 292
 Email info@cvo.co.uk

www.spiritfires.co.uk

Spirit Fires Incorporates the full CVO Fire range of Fires. For more details contact above or visit www.cvo.co.uk

